



6 The Anchorage, Lymm, Cheshire, WA13 0DX

£1,100 PCM





## 6 The Anchorage, Lymm, Cheshire, WA13 0DX

**£1,100 PCM**

\*\*\*DELIGHTFUL TWO BEDROOM MID-MEWS PROPERTY\*\*\* This newly decorated throughout property which is conveniently located close to Lymm village and local amenities and a couple of miles from the M6 and M56 motorway networks. Briefly comprising of a good sized lounge with patio doors leading to a conservatory, fitted kitchen, bathroom, two bedrooms, off road parking for two cars and an enclosed well maintained garden. with a shed for storage. The property is unfurnished except for built in raised bed in one of the bedrooms , this can be removed in necessary.



## Description



Unfurnished  
Council Tax Band: C  
Available:



Floor Plans

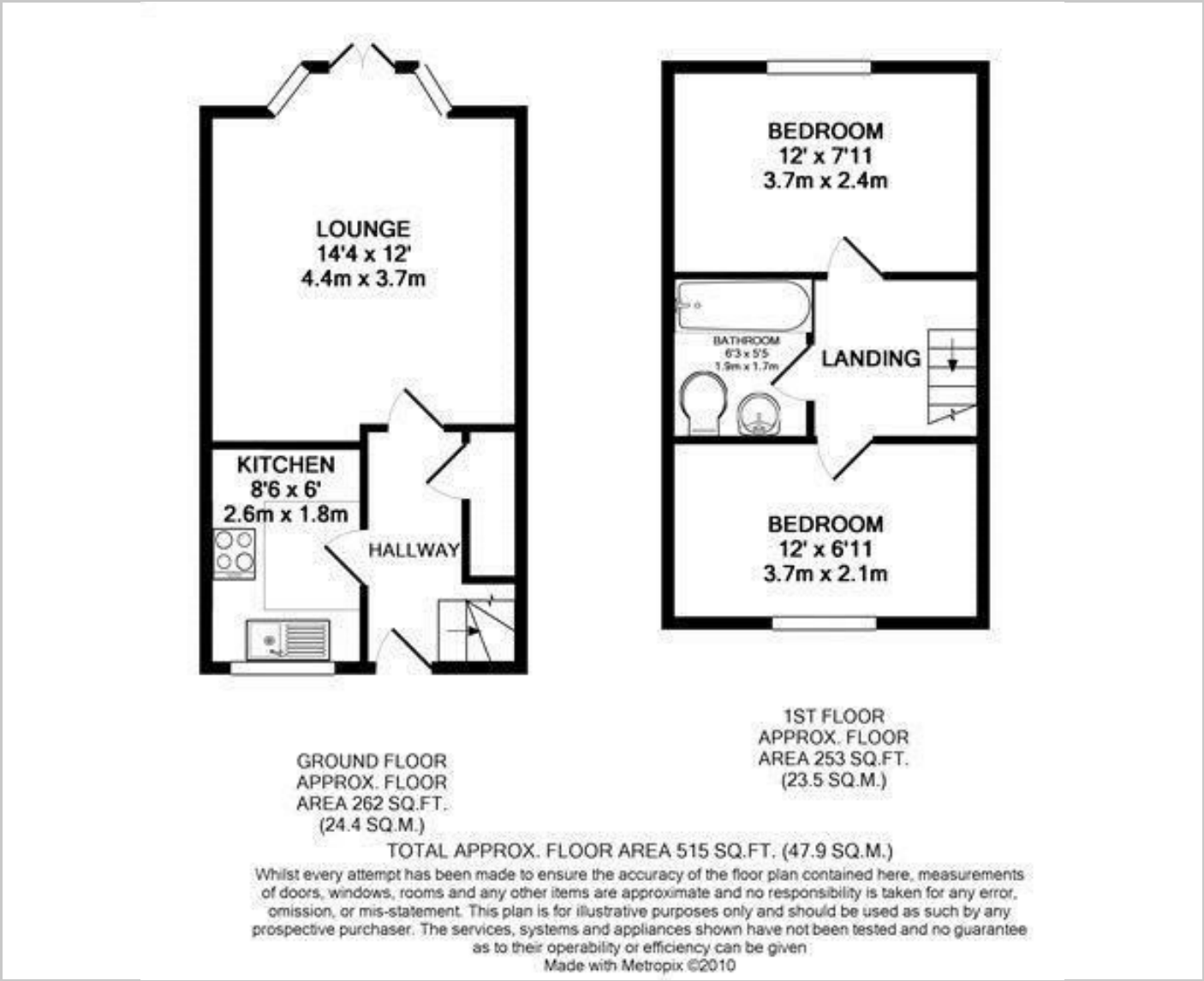

Area Map



Energy Performance Graph



These particulars, whilst believed to be accurate are set out as a general outline only for guidance and do not constitute any part of an offer or contract. Intending purchasers should not rely on them as statements of representation of fact, but must satisfy themselves by inspection or otherwise as to their accuracy. No person in this firms employment has the authority to make or give any representation or warranty in respect of the property.